



motoalliance

23001 Industrial Blvd, Rogers, MN 55374 / 1-866-527-7637
www.motoalliance.com

MOTOALLIANCE WINCH MOUNT

MA11921

Honda Foreman/Rancher/Rubicon 2014+

Thank you for purchasing our MotoAlliance winch mount(s). You now own a premium custom winch mount to allow you to use your winch with your ATV/UTV. Please note the following instructions and heed all warnings.

- Please use common sense when operating your ATV/UTV.
- Read your Winch Operator's Manual and all other Operator Manual's, including warning labels, before operating your ATV/UTV.
- Be observant of moving parts causing entanglement, use extreme caution!

SEVERE INJURY OR DEATH MAY RESULT IF YOU ARE NEGLIGENT.

Please verify that all hardware and parts are included in your package.

Honda Foreman/Rancher 2014+ MA11921



23001 Industrial Blvd
Rogers, MN 55374

Kit Contents:

Item #	Description	Qty
1	MA11921 Base Plate	1
2	MA11921 Fairlead Plate	1
3	5/16" x 1" HH Bolt	2
4	5/16" Flat Washer	2
5	5/16" Nylock Nut	2

INSTALLATION:

1. Begin by pivoting the front bumper forward. Remove the bolts as shown below

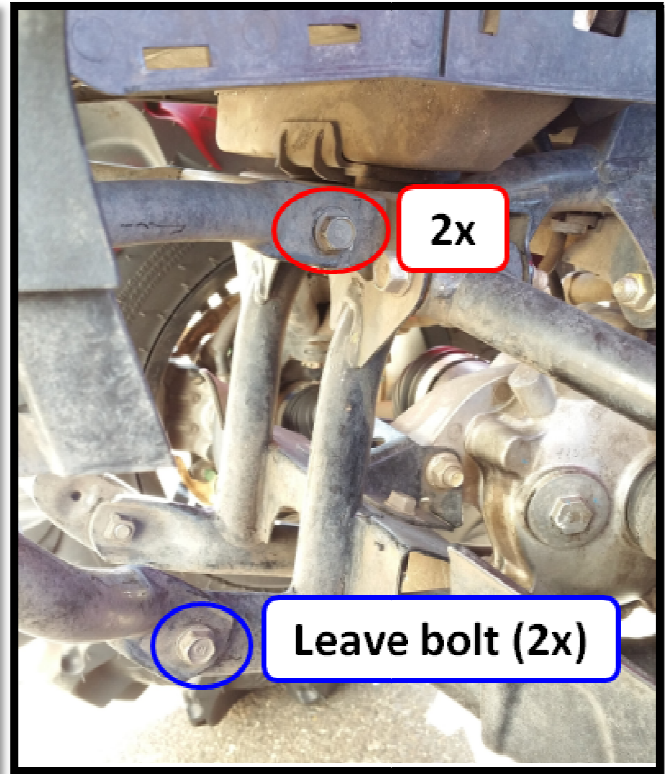
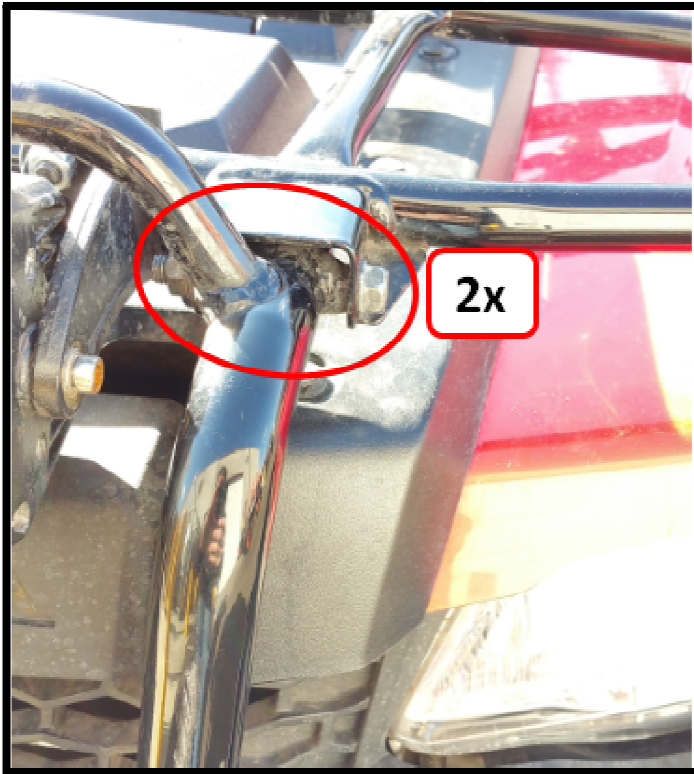
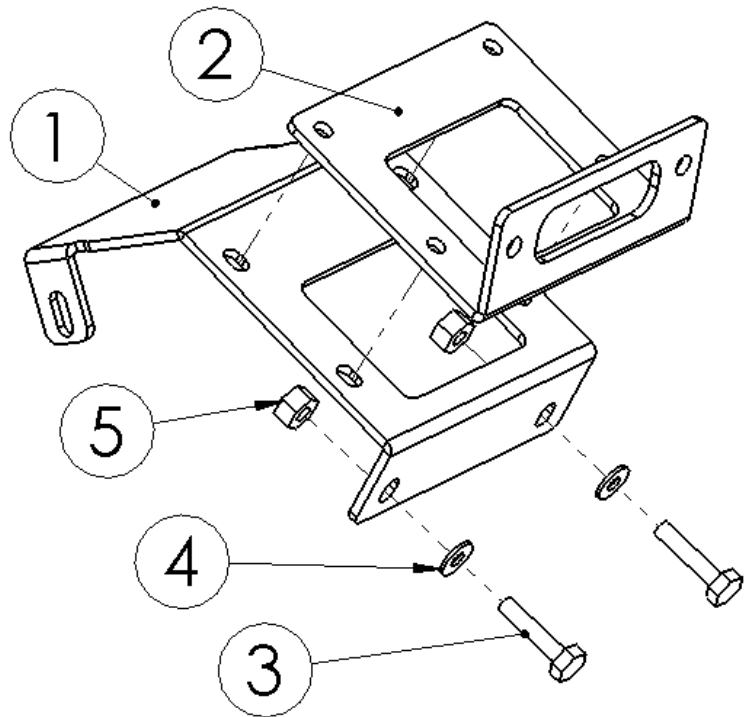

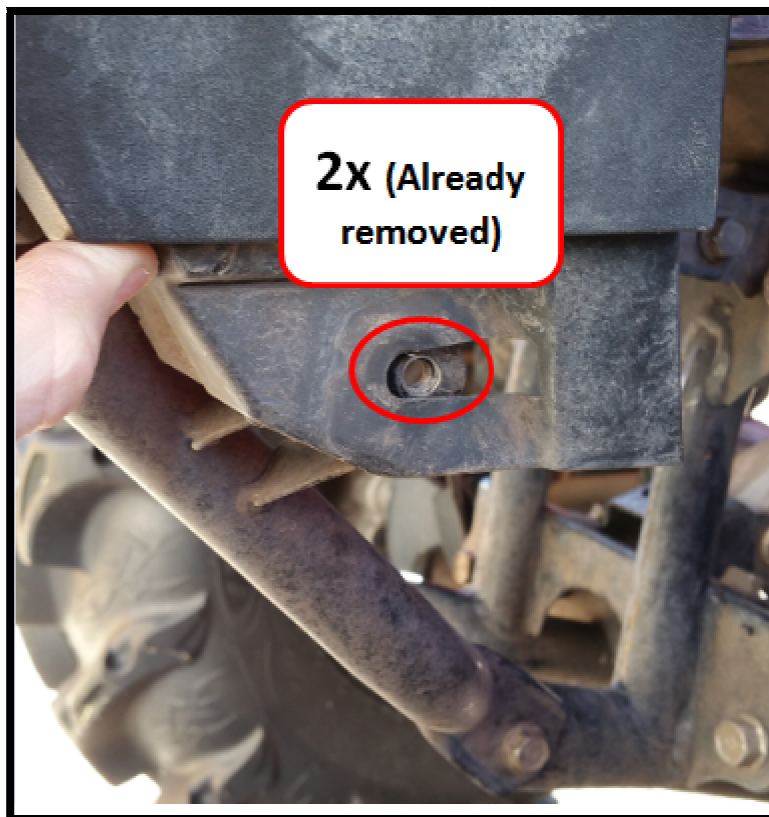

2. With the bolts removed from Step #1, the front bumper will tip forward. Assemble the winch, MA11921 Base Plate (#1) and MA11921 Fairlead Plate (#2) using the hardware that came in your winch kit (See Assembly diagram on Page #2. All Viper winches include a set of (4) M8 x 25mm Hex Bolts, use these to mount the winch to the brackets mentioned above.
3. Set the winch and bracket assembly over the front bumper so that the front lip of the MA11921 Base Plate fits over the front of the bumper as shown. (Do not install the front 5/16" Hex Bolts at this time.

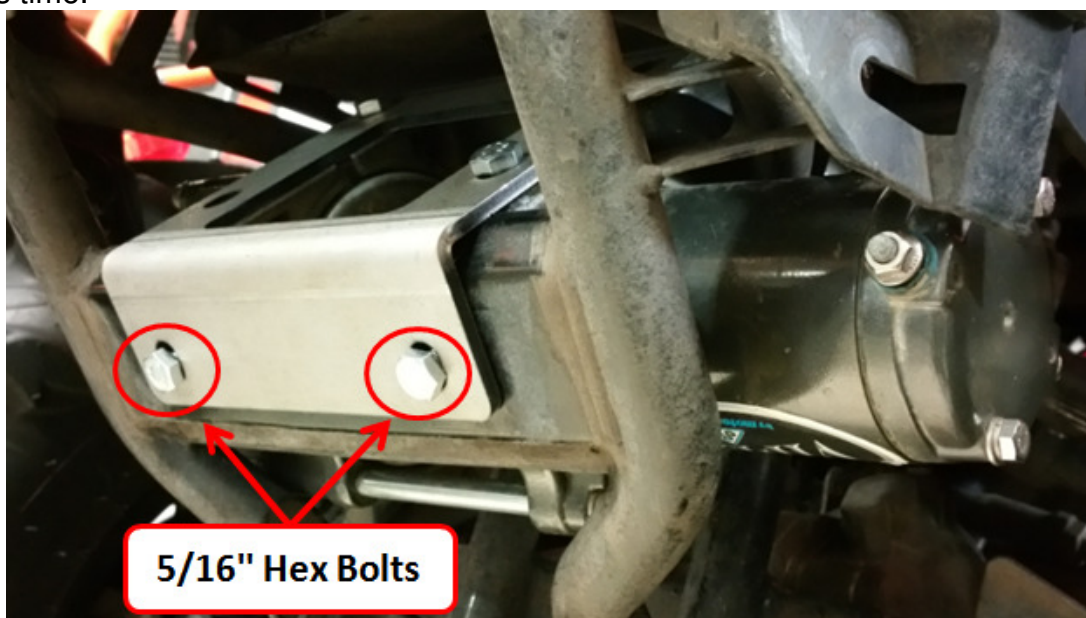

4. Tip the bumper back into place; while doing this, fit the rear tabs of the MA11921 Base Plate over the mounting tabs of the vehicle frame. See image below. Reinstall the set of factory bolts (Circled below) that were removed in Step #1, do not tighten at this point. This will pin the bumper in place.

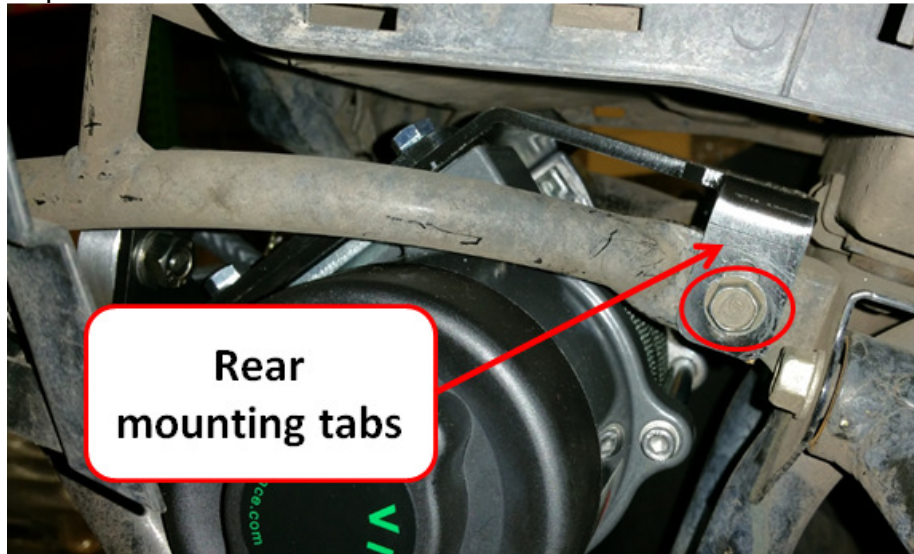

5. Reinstall all the factory bolts and clips that were removed in Step #1 as well as the 5/16" Hex Bolts at the front of the mount plate shown at the bottom of page #3. Do not tighten until all the bolts are installed.
6. A small amount of trimming to the front plastic brush guard may be necessary to refit two of the bumper bolts as shown below.

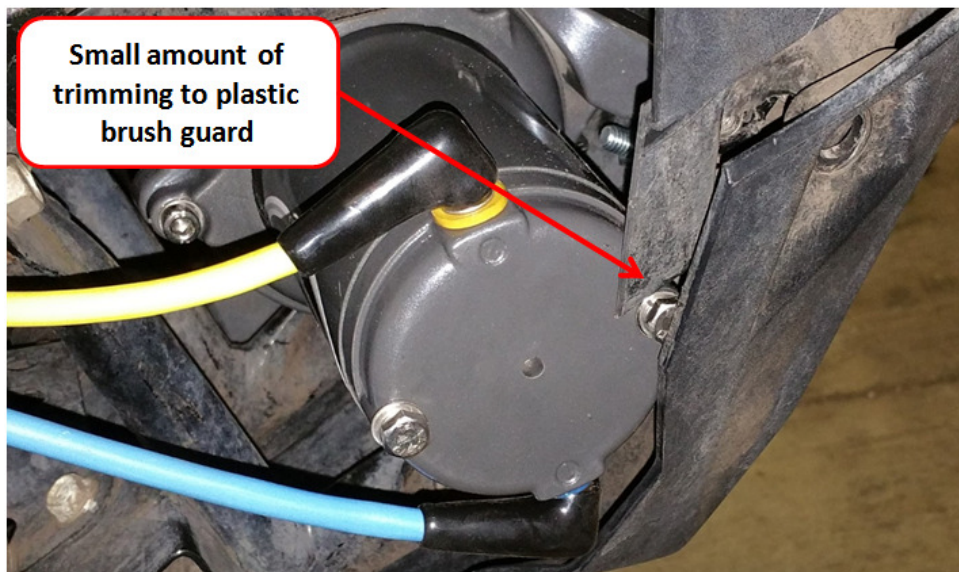

7. Wire the winch per the winch manufacturer's recommendation. The contactor can be located inside the rear storage compartment or mounted to the right hand side of the storage compartment within the wheel well. If mounting within the wheel well, it is best to purchase a small tube of dielectric grease to help protect the electrical connections from road spray and other elements. Note: Always route wires away from hot, sharp and or moving components. The best practice is to follow other OEM wiring harnesses.